



# INSTRUCTION MANUAL

*MODEL #APD15150  
& APW15150*

**COMPRESSED AIR  
POWERED HEPA VAC**



**-----WARNING-----**

All Nikro Industries Inc. products that have rated efficiencies of 99.97% @ 0.3 microns and 99.99% @ 0.3 microns, have H.E.P.A. filters that have been individually tested to meet these minimum efficiencies.

Although all the filters have been pre-tested, the possibility of leaks or filter failure due to handling, transportation, punctures, loaded filters, moisture, wear and tear, etc., does exist.

Therefore, when using this equipment in highly sensitive areas or where any release of particles above and beyond the minimum efficiencies would be detrimental and harmful to humans, plants or property; it is strongly recommended that the units be individually tested prior to their use.

This is to assure that they are maintaining the efficiency levels, which they were designed to filter out.

**FAILURE TO DO SO COULD RESULT IN SERIOUS HARM TO HUMAN LIFE, PLANT LIFE  
AND/OR PROPERTY.**

**1115 N. Ellsworth Ave., Villa Park, IL 60181**

**Telephone: 630-530-0558 FAX: 630-530-0740**

**Toll Free: 800-875-6457**

# AIR OPERATED VACUUM CLEANERS

## OPERATION AND MAINTENANCE, MANUAL WITH ILLUSTRATED PARTS LIST

Read and follow all instructions, warnings, and cautions before using this machine.

These instructions are for your protection and convenience. Please read them carefully since failure to heed these precautions could result in discomfort or injury. When using compressed air equipment, basic safety precautions should always be followed.

### SAFETY INSTRUCTIONS

Air supply should not exceed 100 PSI

Use a compressor and air line that meet the requirements listed below on the specifications chart

Water separator must be used on compressed air line.

Air control valve must be off before connecting to compressed air line, then open valve slowly, making sure not to exceed the 100 PSI rated pressure.

When cleaner is running, never allow fingers, hair, or loose clothing to come near intake, suction ports, or nozzle.

Replace damaged or worn parts immediately with genuine original equipment parts to maintain safety and to protect your limited warranty.

Not recommended for drums with walls and bottoms thinner than 20 gauge.

NEVER LEAVE VACUUM UNATTENDED WHEN CONNECTED TO AIR LINE.

## SPECIFICATIONS

								Compressed Air Requirements		
Model #	Tank Size	Tank Construction	Static Lift	C.F. M.	Dry Pickup	Wet Pickup	Filtration	C.F.M.	P.S.I	Air Hose ID
AHD15150	15 Gal	Painted Steel	150"	90	Yes	Opt.	99.97% at 0.3 micron	20	100	1 / 2"
AHD15225	15 Gal	Painted Steel	225"	120	Yes	Opt.	99.97% at 0.3 micron	100	100	3 / 4"
AHW15150	15 Gal	Painted Steel	150"	90	Yes	Yes	99.97% at 0.3 micron	20	100	1 / 2"
AHW15225	15 Gal	Painted Steel	225"	120	Yes	Yes	99.97% at 0.3 micron	100	100	3 / 4"
AHD15150-S	15 Gal	Stainless Steel	150"	90	Yes	Opt.	99.97% at 0.3 micron	20	100	1 / 2"
AHD15225-S	15 Gal	Stainless Steel	225"	120	Yes	Opt.	99.97% at 0.3 micron	100	100	3 / 4"
AHW1550-S	15 Gal	Stainless Steel	150"	90	Yes	Yes	99.97% at 0.3 micron	20	100	1 / 2"
AHW15225-S	15 Gal	Stainless Steel	225"	120	Yes	Yes	99.97% at 0.3 micron	100	100	3 / 4"
APD15150	15 Gal	Polyethylene	150"	90	Yes	Opt.	99.97% at 0.3 micron	20	100	1 / 2"
APD15225	15 Gal	Polyethylene	225"	120	Yes	Opt.	99.97% at 0.3 micron	100	100	3 / 4"
APW15150	15 Gal	Polyethylene	150"	90	Yes	Yes	99.97% at 0.3 micron	20	100	1 / 2"
APW15225	15 Gal	Polyethylene	225"	120	Yes	Yes	99.97% at 0.3 micron	100	100	3 / 4"
AHD55225	55 Gal	Painted Steel	225"	120	Yes	Opt.	99.97% at 0.3 micron	100	100	1 / 2"
AHD55TWN	55 Gal	Painted Steel	225"	195	Yes	Opt.	99.97% at 0.3 micron	200	100	3 / 4"

## **PROCEDURES FOR REMOVING CONTAMINATED FILTERS .**

### **Caution:**

When removing contaminated filters or using this machine, you should always wear gloves, clothing and a respirator approved for the particular contaminant which you are working with.

### **FILTER REMOVAL PROCEDURES**

1. Turn off and unplug machine
2. Slowly and carefully lift one side of the lid assembly from the tank. Holding the lid with one hand, reach under the lid and gently tap all around the dacron filter bag, allowing any loose dust particles to drop into the tank.
3. Carefully lift the lid assembly off the tank. With a damp rag, wipe underside of the lid assembly. Set it aside and dispose of rag properly. (Never set the lid assembly down on the HEPA filter).
4. Remove the impaction prefilter. (Refer to the following section "Procedure on changing the impaction filter").
5. Carefully pull the paper filter protector bag over the rim of the tank and push it down into the tank.

**Caution:** Be careful not to create any airborne dust by snapping the elastic bag

6. Take the collar of the paper collection bag and carefully slide it down and off the down tube and remove the collection bag from the tank.
7. Take a damp rag and wipe down the inside of the tank. Dispose of contaminated rag properly.
8. All hazardous waste must be disposed of properly. Never put contaminated debris in a regular trash container. All debris must be placed in a bag or container labeled "Hazardous Materials", and should be removed by a licensed waste hauler.

### **CONSULT PROPER AUTHORITIES FOR REGULATIONS REGARDING DISPOSAL**

### **PROCEDURE ON CHANGING THE IMPACTION FILTER**

1. The precautionary steps described in this manual should be used when changing the impaction prefilter.
2. The impaction prefilter should be changed when any of the following occur.
  - A. Whenever a tear is found in any of the filters preceding the impaction filter.
  - B. At least every other time the collection bag is changed.
3. To change the impaction prefilter, follow the first three procedures in the section on "Filter Removal Procedures" and then proceed.
4. Carefully slide the non-clinging dacron bag off the HEPA filter and set aside.
5. Remove the impaction prefilter from the HEPA filter. (Never use any type of tool or object to remove this filter, to insure that you do not puncture the HEPA filter). This filter cannot be cleaned or reused and should be disposed of properly.

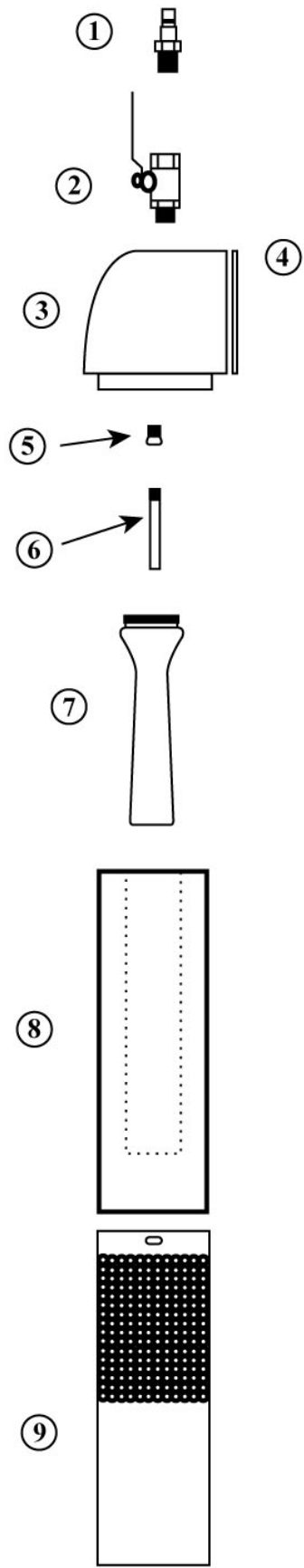

REFERENCE	PART NO.	DESCRIPTION.
1	860527	AIR LINE CONNECTOR
2	860528	SHUT-OFF VALVE
3	860529	VENTURI BOX
4	860530	VENTURI BOX GASKET
5	860531	BRASS BRUSHING
6	860532	AIR JET, 150 STATIC LIFT
	860533	AIR JET, 225 STATIC LIFT
7	860534	VENTURI
8	860535	FOAM INSERT (EXHAUST SILENCER)
9	860536	EXHAUST HOUSING

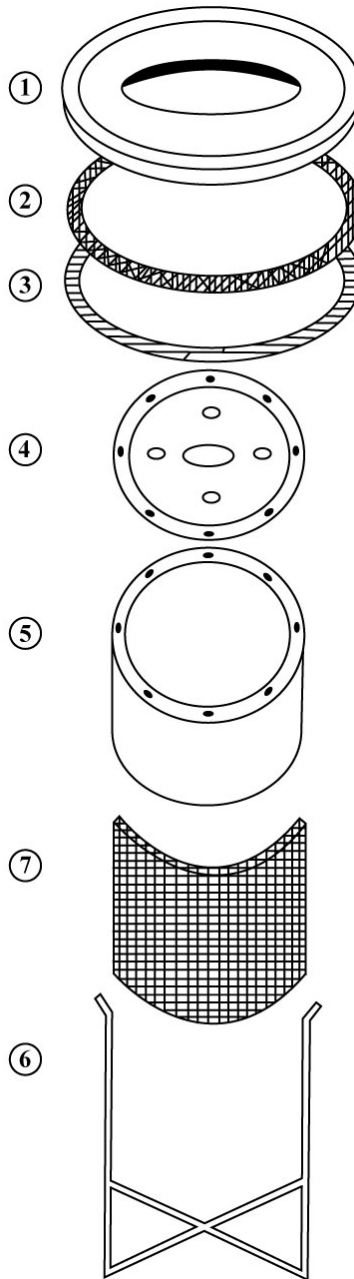

REFERENCE	PART NO.	DESCRIPTION	QTY. REQ.
1	520008	LID (15 GAL.)	1
2	520018	LID GASKET	1
3	520014	LID EDGING GASKET	1
4	520367	FILTER MOUNTING PLATE	1
5	520307	HEPA FILTER	1
6	520366	FILTER PROTECTOR CAGE	1
7	520316	IMPACTION FILTER - PINK	1

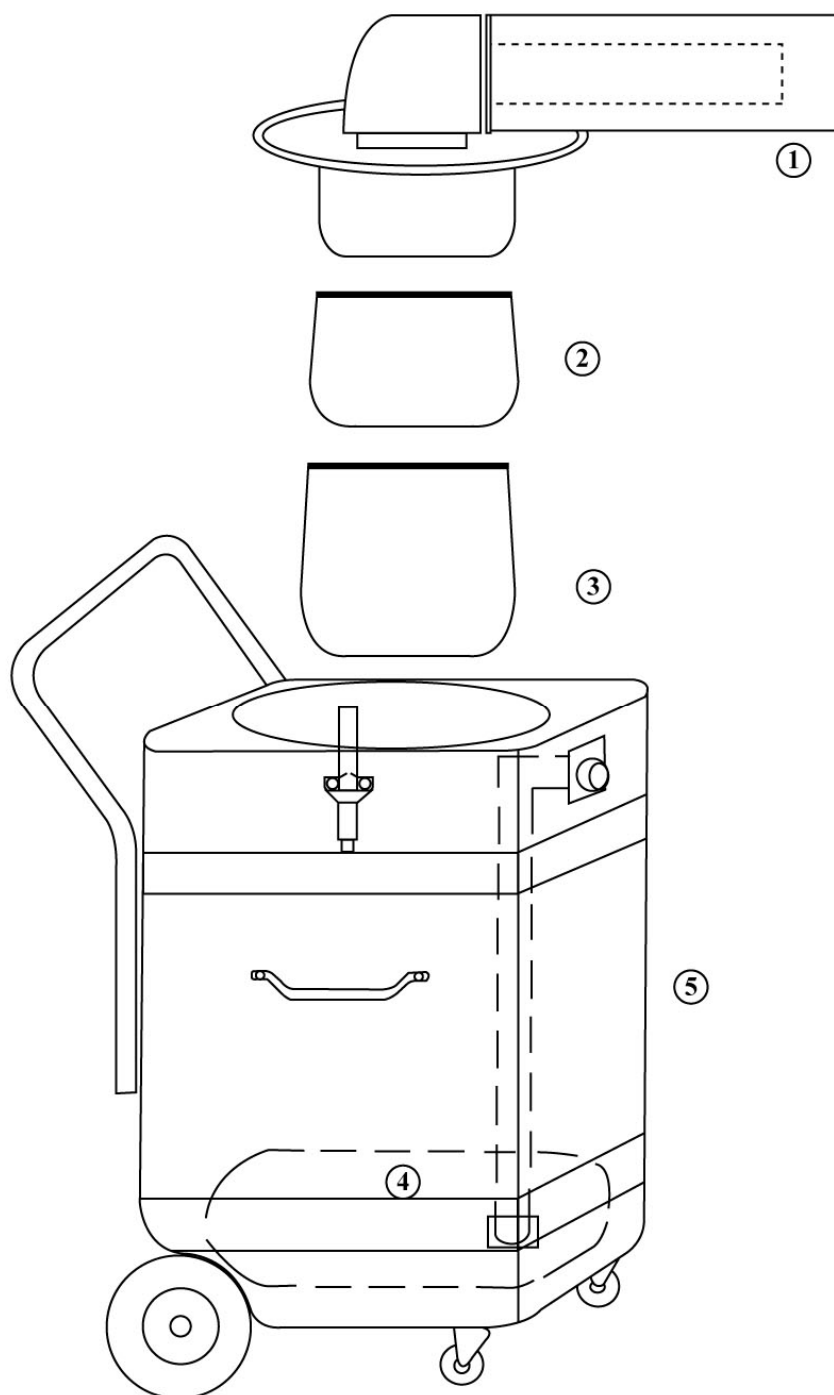

REFERENCE	PART NO.	DESCRIPTION	QTY. REQ.
1	861157	PNEUMATIC HEAD ASSY.	1
2	520210	DACRON FILTER BAG	1
3	520034	FILTER PROTECTOR	1
4	520032	COLLECTION BAG	1
5	860805	TANK AND CART ASSY.	1

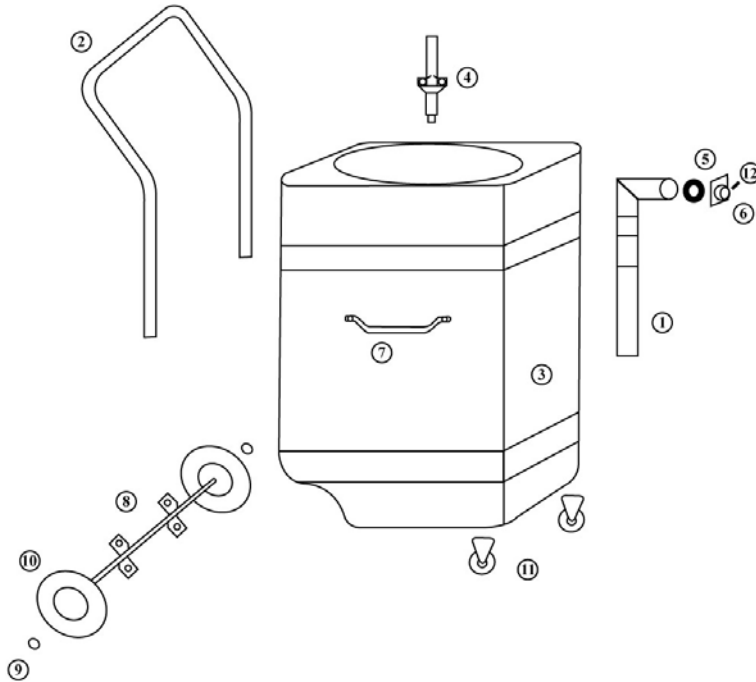

#520321-DOWN TUBE ASSY.

INCLUDES

540001 DOWN TUBE ELBOW

860468 DOWN TUBE COUPLER

(RUBBER)

860360 DOWN TUBE 8" LG. X 2" DIA  
TUBE

REFERENCE	PART NO.	DESCRIPTION	QTY. REQ.
1	520321	DOWN TUBE ASSY.	1
2	860550	HANDLE	1
3	860802	15 GAL. POLY TANK	1
4	860803	LID LATCH	2
5	520216	INTAKE GASKET	1
6	860549	HOSE INTAKE	1
7	520222	TANK SIDE HANDLE	2
8	860584	AXEL ASSY.	1
9	860801	NYLON INSERT NUT (1/2-13)	2
10	520227	REAR WHEEL	2
11	860804	FRONT CASTER	2
12	520217	INTAKE KNOB	1



**ET PICK-UP  
CONVERSION**

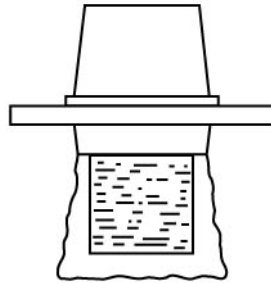

LID ASSY.

520037  
DACRON FILTER BAG

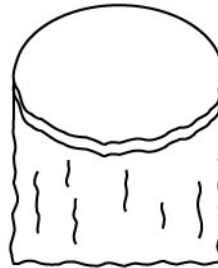

520034  
FILTER PROTECTOR

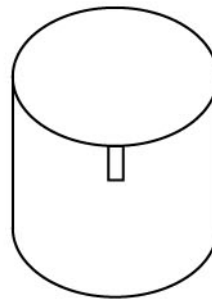

520315  
WATER PICK-UP ADPT.

**WARNING:**  
FOR SAFE AND PROPER WATER PICK-UP,  
THE CONVERSION ASSY. MUST BE  
ASSEMBLED EXACTLY AS SHOWN

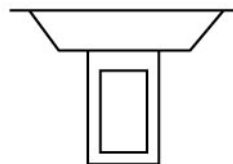

520317  
WATER SHUT-OFF

**IMPORTANT:**  
WHEN CONVERTING FOR WET PICK-UP,  
THE UPPER CLAMP ON THE DOWN  
TUBE (LOCATED INSIDE THE TANK  
ASSY.) MUST BE LOOSENED AND  
BOTTOM HALF OF THE TUBE REMOVED;  
THIS WILL PREVENT WATER FROM  
SPLASHING UP ONTO THE HEPA FILTER.

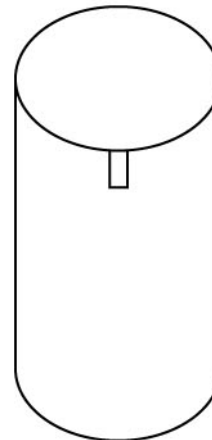

15 GAL. TANK ASSY.

## **WARRANTY**

Nikro equipment is warranted for 2 years from the date delivered to the original purchaser. Parts, which become defective due to faulty workmanship or materials during normal use in these years will be repaired or exchanged at no charge if returned and approved by an authorized Nikro service center. The freight shall be at the expense of the customer.

This warranty does not apply to normal wear and tear, neglect, misuse, or incorrect installation. If any other replacement parts, filters or attachments are used other than original Nikro parts, this warranty will become void.

This warranty does not apply to hoses, switches, lights, sensors, or breaks in cords. All motors are subject to manufacturer's warranty. Contact Nikro Industries for assistance with these items.

Nikro disclaims responsibility for loss of production, profits, or any other costs that may indirectly occur due to the failure of this product.

***NIKRO***  
**INDUSTRIES, INC.**